



## Main features

The Single phase hopper loader is completely stainless steel control keyboard, display and alarm lamp. It is equipped with the Soft-Start technology that allows a gradual start of the blower motor, in order to reduce the consumption. This device assures a progressive voltage to the motor by a starting ramp, avoiding all instantaneous starts and allows a strong energy saving.

1. Filter cleaning with blasts compressed air tank.
2. Polyester tissue filter with large filtering surface. Cover lid with labyrinth seal and 2 locking clamps.
3. Discharge outlet with gasket.
4. Microprocessor electronic control with easy and friendly interface.

### Functions:

- Loading times setting
- Filter cleaning setting
- Ratio valve control
- Material shortage visual alarm.
- Brush wear visual alarm.



## Technical specifications and dimensions - VHL 2

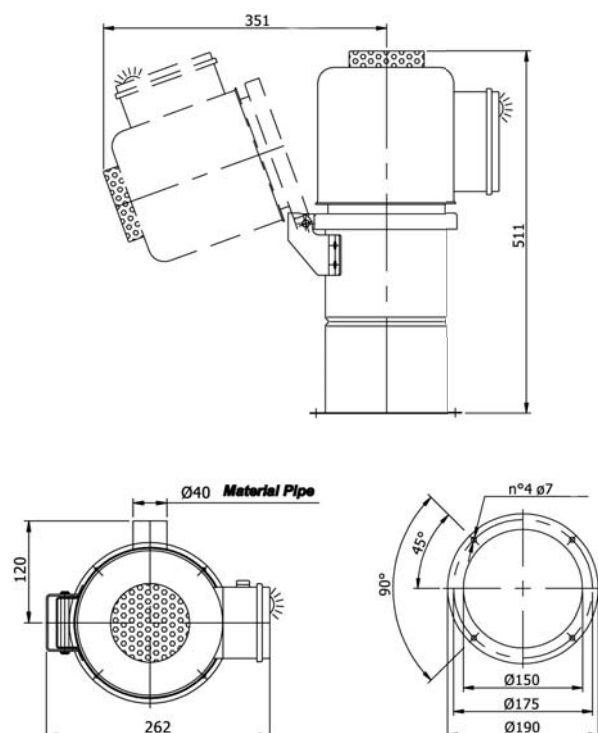

MODEL	VHL 2
CODE	01426
THROUGHTPUT	40 kg/h
VOLTAGE	230 V , 50-60 Hz
MOTOR POWER	1 kW
STATIC DEPRESSION	210 mbar
CAPACITY	1 dm <sup>3</sup>
COMPRESSED AIR PRESSURE	6 - 8 bar
COMPRESSED AIR CONSUMPTION CYCLE	4 NI
WEIGHT	7 kg
MAXIMUM PROCESS TEMPERATURE	80 °C
NOISE LEVEL	<76 d/B(A)

## Technical specifications and dimensions - VHL 10

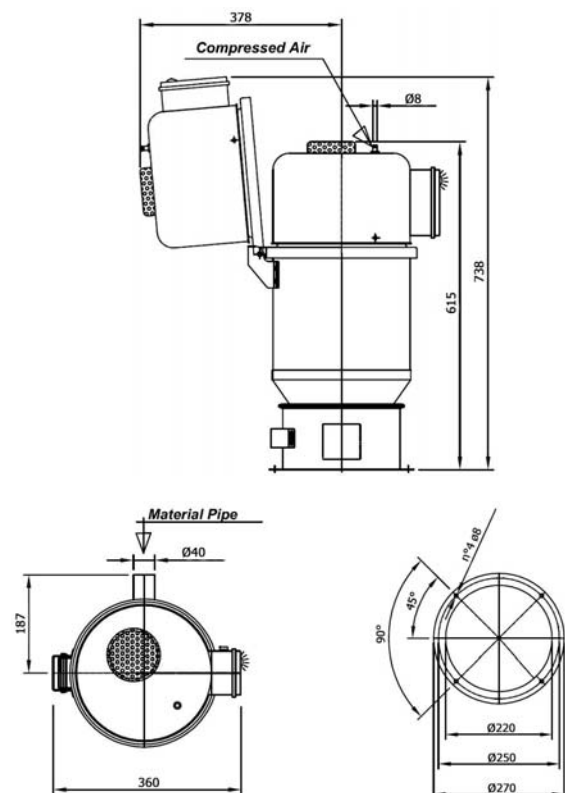

MODEL	VHL10
CODE	01613
THROUGHTPUT	90/100 kg/h
VOLTAGE	230 V , 50-60 Hz
MOTOR POWER	1 kW
STATIC DEPRESSION	210 mbar
CAPACITY	10 dm <sup>3</sup>
COMPRESSED AIR PRESSURE	6 - 8 bar
COMPRESSED AIR CONSUMPTION CYCLE	6 NI
WEIGHT	13 kg
MAXIMUM PROCESS TEMPERATURE	80 °C
NOISE LEVEL	<76 d/B(A)